

CCAS2131

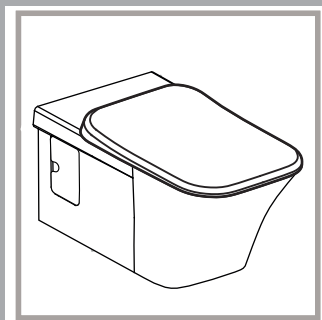

American Standard

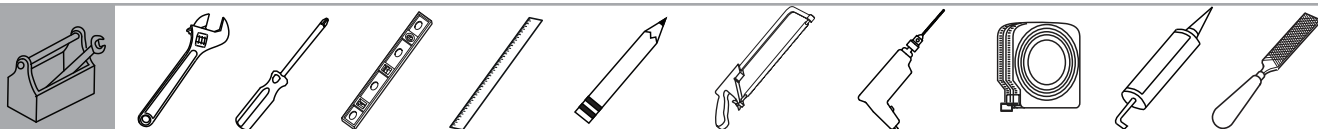
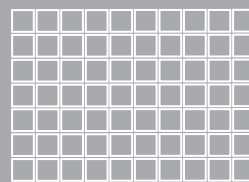

**CCAS3131-
3W20400F0**

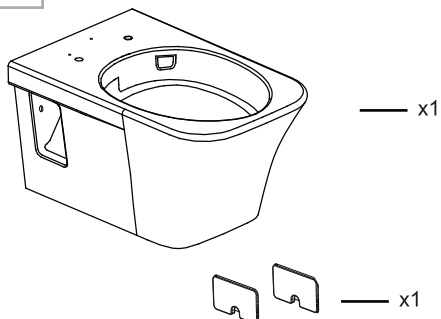

**CCASC131-
U200410F0**

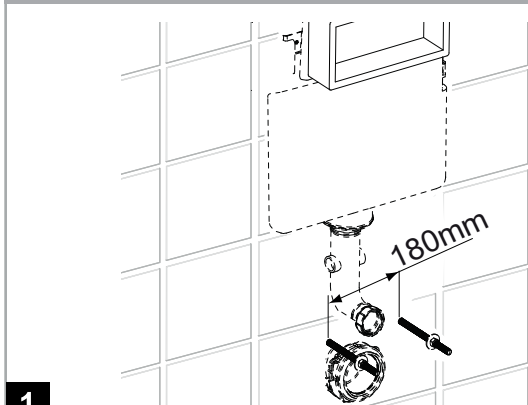
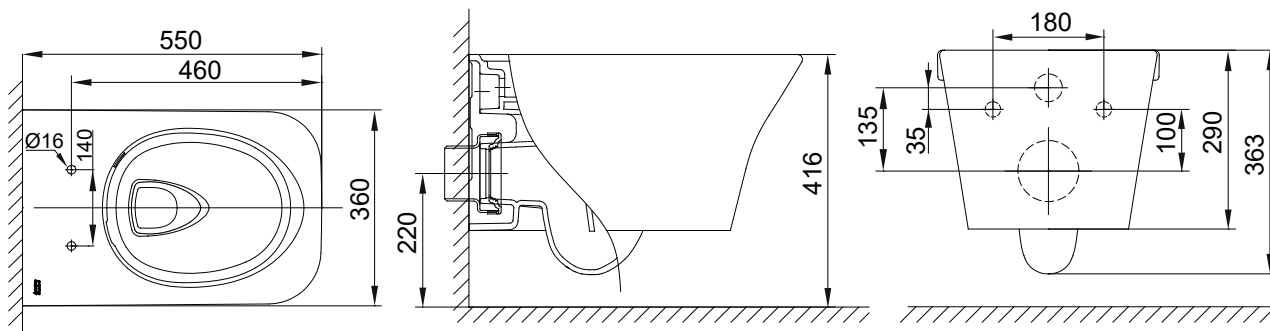

1

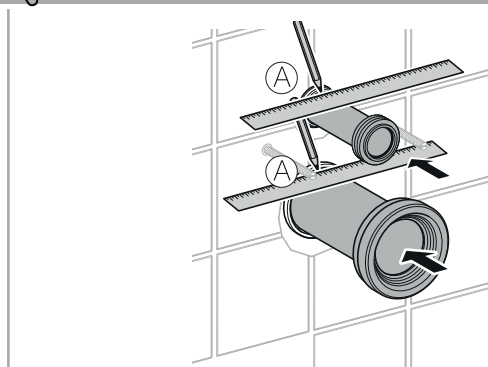

2

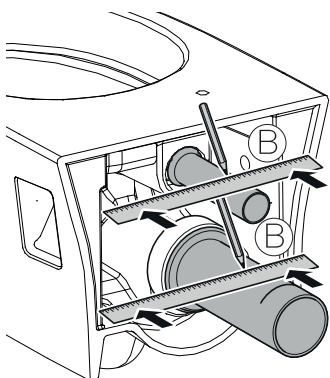

3

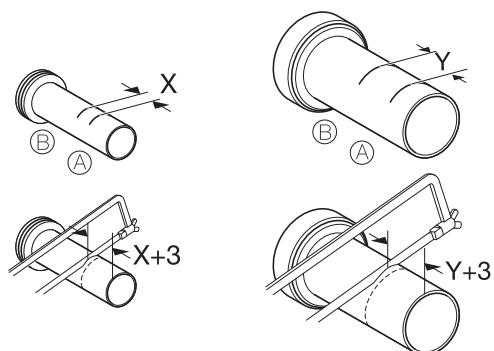

4

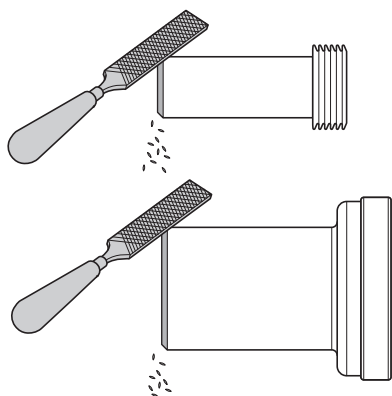

5

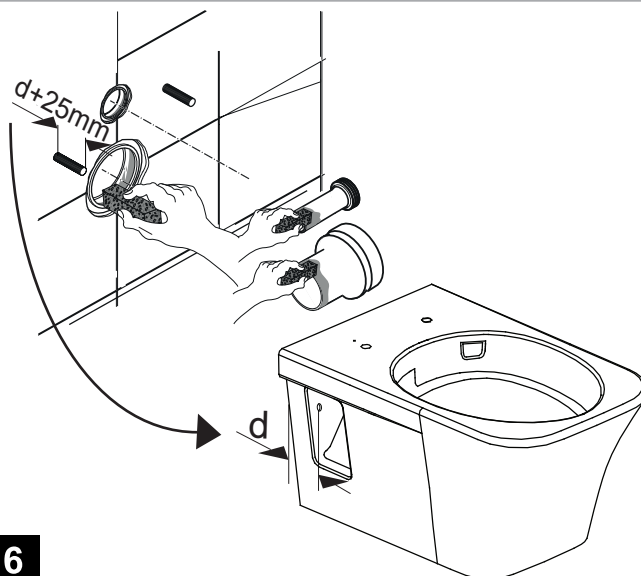

6

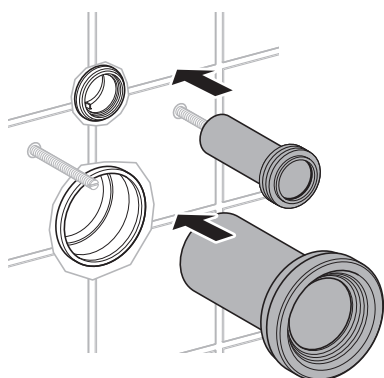

7

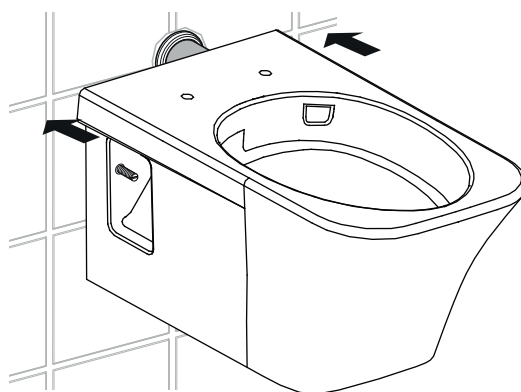

8

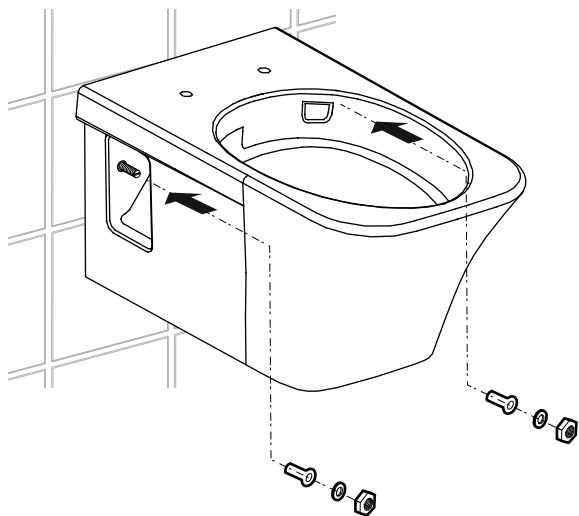

9

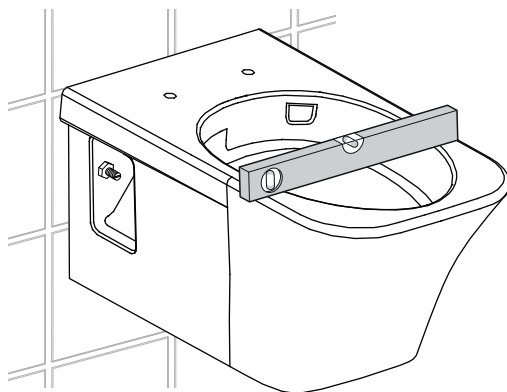

10

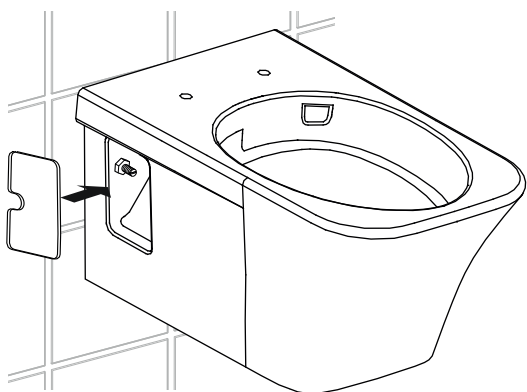

11

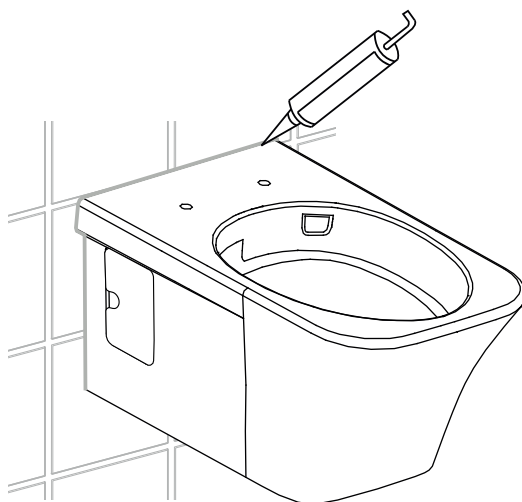

12

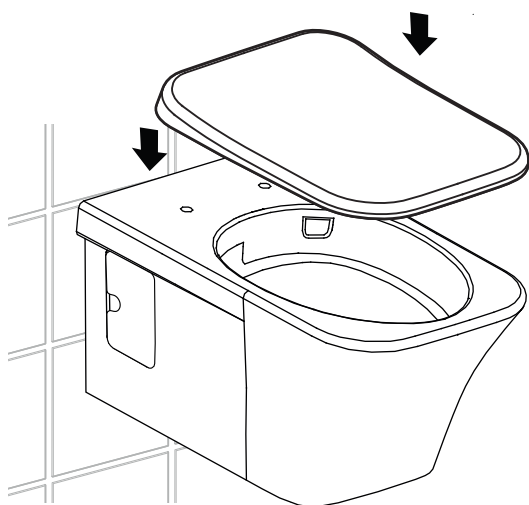

13

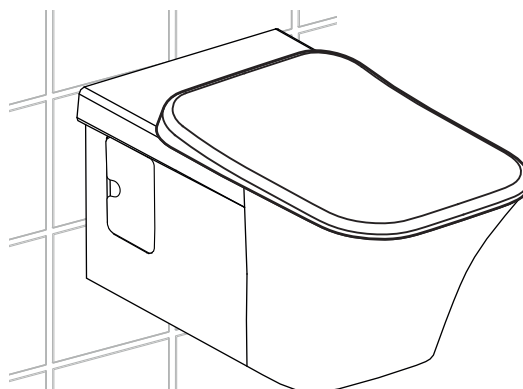

14

BEFORE YOU BEGIN

- Thank you for selecting our products...products which have been the benchmarks of fine quality for years. To help ensure that the installation process will proceed smoothly, please read these instructions carefully before you begin. Also, review the recommended tools and materials list use carefully unpack and examine your new plumbing fixture
- ALL INSTALLATION PROCEDURES MUST COMPLY IN STRICT ACCORDANCE WITH APPLICABLE LOCAL PLUMBING AND BUILDING CODE.
- This installation manual is only for installing the ceramic parts. For the tank trim or seat & cover or concealed tank installing, please refer to relative manual.
- Fragile products. Be careful to avoid the risk of product break or personal injury.

NOTES

- Do not throw blocked material into the toilet, like newspaper, paper diaper, Sanitary napkin etc.
- Do not use heavy power to hit the product, avoid water leakage of product damage.
- Do not use the product when water temperature is below zero degree centigrade.
- The unit is millimeter by default, if the drawings are not indicate.

TROUBLE SHOOTING GUIDE

Using this guide and referring to the accompanying instructions should help you solve most common problems

Problem	Possible cause	To correct
1. Poor flushing action	a. Water level in tank is below prescribed level. b. Flush valve in tank closes too quickly or does not open. c. Flush handle or button needs replacing. d. Water pressure is too low. e. Partially clogged trapway and / or drainpipe. f. No air vent. g. Air tube leakage.	a. Set to prescribed level. b. Make sure there are no any material stuck to flush valve. c. Replace. d. Normal water supply pressure must be at least 20 psi. e. Use a plunger or toilet augur to unclog. f. Install air vent per instructions. g. Reconnect air tube or change.
2. Water won't stop running	a. Water level in tank is higher than overflow pipe. b. Turn off the water supply. If water continues to flow into the bowl, check flush valve deformed or not, or check rubber gasket poor sealing or not. c. Turn off the water supply valve. If water continues to flow into the bowl until the water level falls to the level of the overflow pipe, sand or debris may be lodged in the water control mechanism. d. Air tube needs to replace	a. Adjust the cylinder to maintain the water at the prescribed level. b. Replace seat, rubber seal disk, or complete assembly, as needed. c. Shut off water supply valve. Remove top cap of water control. Clean and reassemble, or replace plunger. d. Replace air tube.
3. Water supply hose leaks	a. Improper installation b. Water pressure is too high.	a. Reinstall according to instructions. b. Water pressure must not exceed 80 psi.

CARE AND MAINTENANCE

Do not use harsh abrasives or caustic cleansers to clean fixture surface. A mild detergent, warm water, and a soft cloth will remove normal dirt and soap accumulations from fittings and surfaces. Rinse thoroughly after cleaning and polish with a soft dry cloth to restore original luster of material.

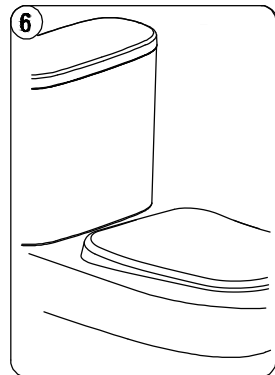
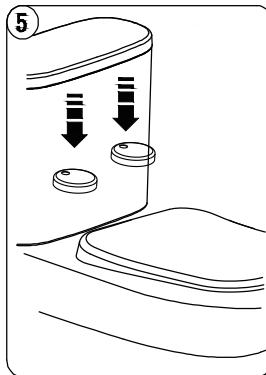
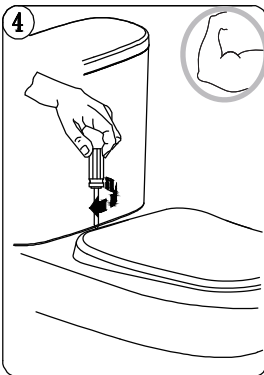
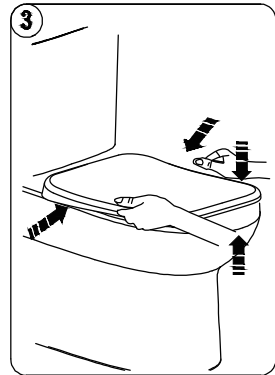
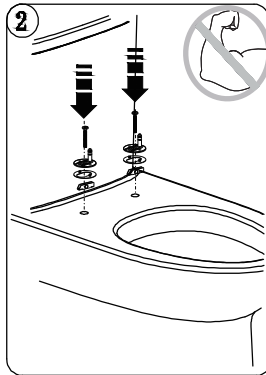
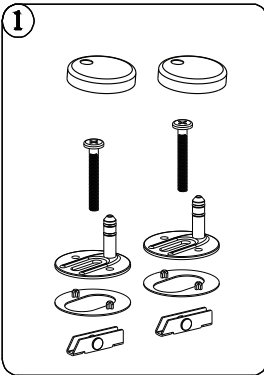
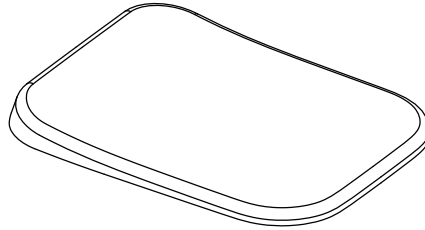
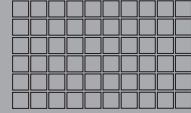

Warning: Do not stand or place heavy objects on the seat cover. Do not use inappropriate cleaners (toilet cleaner, residential cleaner, bleach, benzene, paint thinner, cleaning powder, cresol or any other strong acid and strong alkali, ect corrosive solution) to clean the seat cover or hinge base. Wipe seat and cover with the wet and soft cloth that is wrung dry. Keep children out of the seat, to avoid body injury. Do not open/close the seat and cover using excessive force. Do not expose the product to direct sunlight.