

Tolerance, Unless Otherwise Stated, Is			
Above	0.5 to and including	6	±0.1
Excess	6 to and including	30	±0.2
Excess	30 to and including	120	±0.3
Excess	120 to and including	315	±0.5
Excess	315 to and including	1000	±0.8
Excess	1000 to and including	2000	±1.2

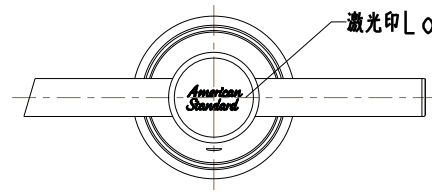

SCALE 0.500

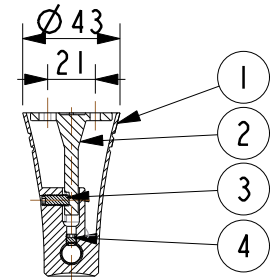
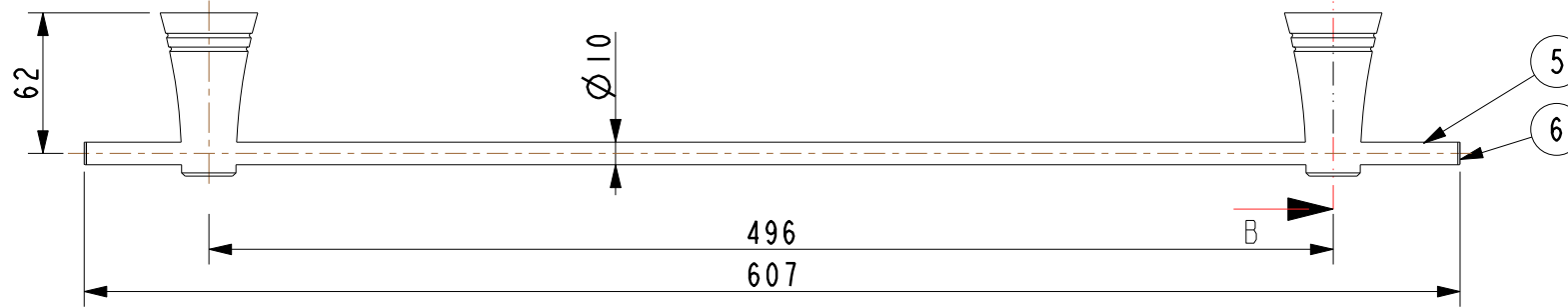

SECTION B-B

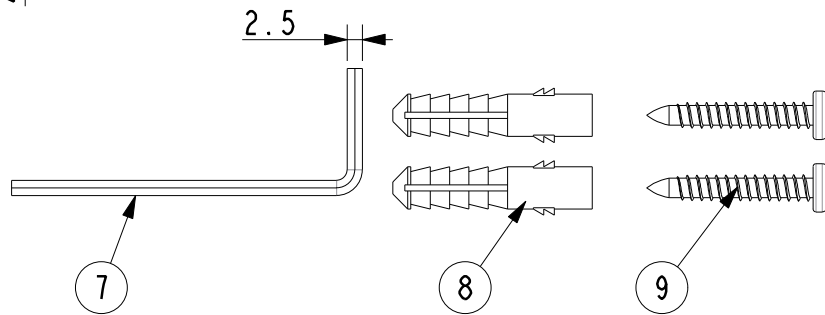
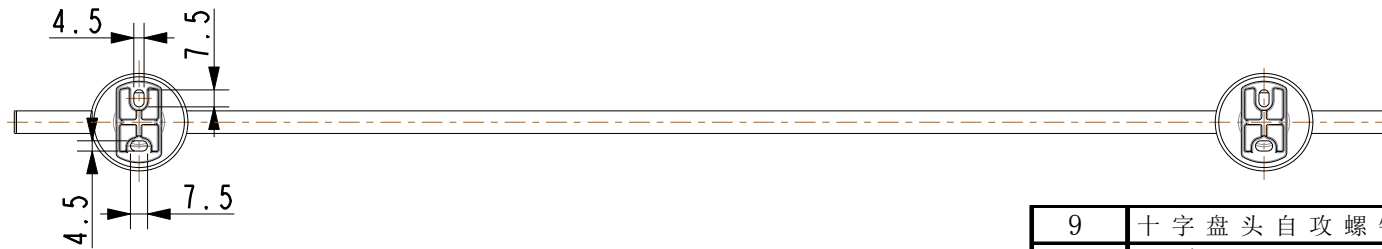

SCALE 0.800

技术要求:

- 按进料检验标准 WI10.3204 《浴室配件》 进行检验。
- 图示所有尺寸为成品尺寸, 要求是一般尺寸。

9	十字盘头自攻螺钉	4	SUS 304	ST4 *40
8	胀套	4	POM	φ 7.5*37
7	六方扳手	1	SUS 304	
6	端盖	2	HP b59-1	镀铬
5	毛巾杆	1	SUS 304	
4	固定螺钉 (短)	2	SUS 304	
3	固定螺钉 (长)	2	SUS 304	
2	支座	2	ZZ n A14-1	镀铬
1	本体	2	ZZ n A14-1	镀铬
序号	品名	数量	材料	备注

DESIGNED			TITLE	
CHECKED			REF	
APPROVED			塞弗毛巾杆	
SCALE	MATERIAL	WEIGHT		
0.300	Assembly		FFAS6588-908500BF0	<i>American Standard</i>

REV	DESCRIPTION	DATE	NAME