

Tolerance, Unless Otherwise Stated, Is			
Above	0.5 to and including	6	±0.1
Excess	6 to and including	30	±0.2
Excess	30 to and including	120	±0.3
Excess	120 to and including	315	±0.5
Excess	315 to and including	1000	±0.8
Excess	1000 to and including	2000	±1.2

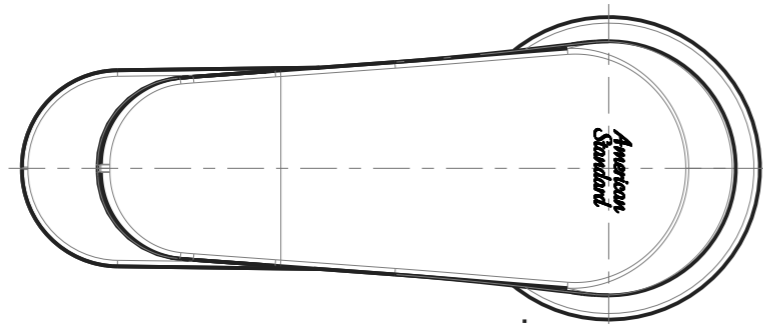
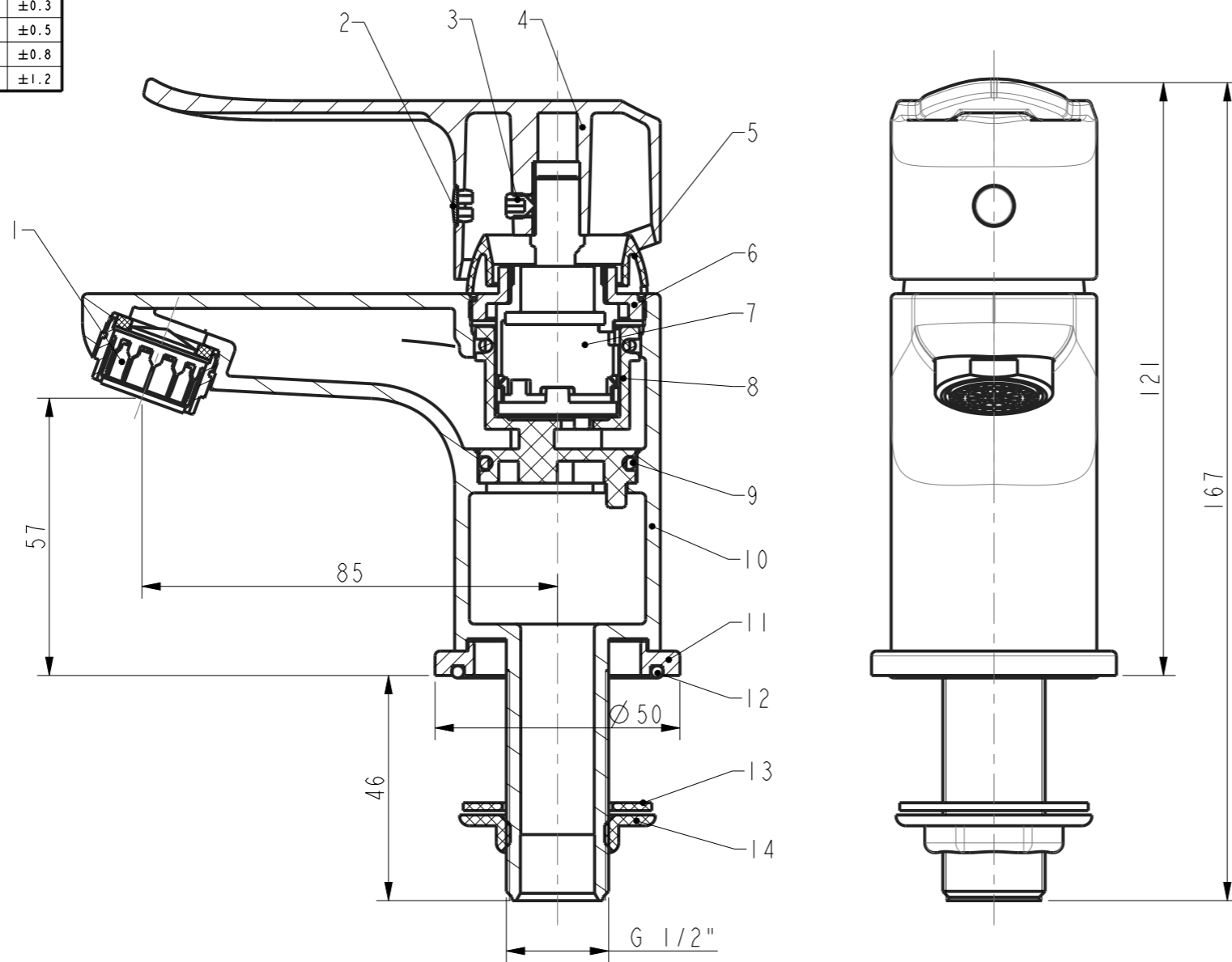

Technical requirements:

1. Cartridge tightening torque is 6 ~ 8 N.M, and the other torque is implemented according to the "WI09.1520 assembly torque specification".
2. O ring coated lubricating oil PMX200;
3. The finished product should meet TIS 2067-2552 and WI10.0507 final inspection standard.

14	FF1-CN521N00002399	Plastic Nut G1/2	1	ABS	
13	FF1-CN521G00000074	washer 38.5* 22.5*1.6	1	NBR	
12	FF1-CN521G00000148	O ring 38.25*2.5	1	NBR	
11	FF1-CN521G000003150	Bottom wahser	1	ZZnAL4-1	
10	FFZZ0021-0013950PL	Body	1	GkMs60Fk	
9	FF1-CN521G000000006	O Ring28*2. 65	2	NBR	
8	FF1-CN521J000008799	Cartridge Manifold	1	PP0+GF30	
7	FF1-CN521C000000011	Cartridge 25mm	1	Assembly	
6	FF1-CN521N000002599	Cartridge nut	1	HPb59-1	
5	FF1-CN521F000000041	Cartridge cover	1	ABS	
4	FF1-CN521L000000090	Handle	1	ZZnAL4-1	
3	FF1-CN521N000000228	Screw M5	1	SUS304	
2	FF1-CN521Z000000083	Handle Cover	1	ABS	Blur
1	FF1-CN521A0001450B	Aerator	1	Assembly	
No.	Part Code	Description	Qty	Material	Remark

DESIGNED			TITLE		
CHECKED			REF		
APPROVED			Neo Modern SH Basin Mono		
SCALE	MATERIAL	WEIGHT	DWG NO.		
4:5	Assembly		FFAS0706-101500BF0		

REV	DESCRIPTION	DATE	NAME

American Standard