

Tolerance, Unless Otherwise Stated, Is			
Above 0.5 to and including 6	6		±0.1
Excess 6 to and including 30	30		±0.2
Excess 30 to and including 120	120		±0.3
Excess 120 to and including 315	315		±0.5
Excess 315 to and including 1000	1000		±0.8
Excess 1000 to and including 2000	2000		±1.2

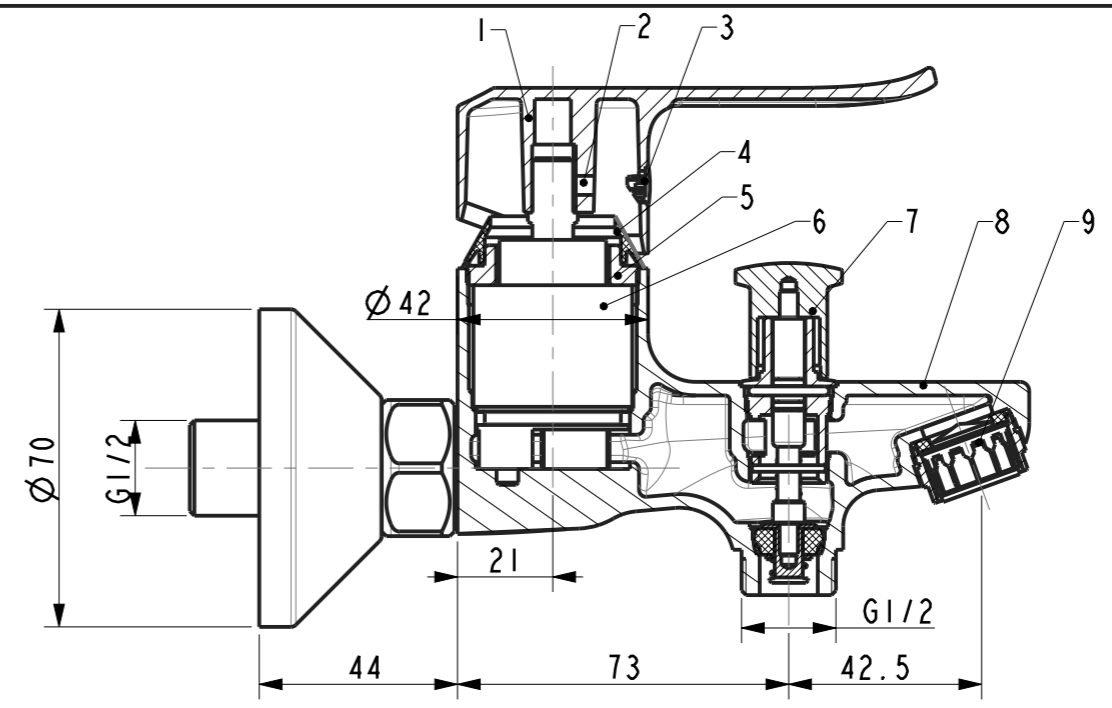

Technical requirements:

1. Cartridge tightening torque is 8 ~ 10 N.M, and the other torque is implemented according to the "WI09.1520 assembly torque specification".
2. The finished product should meet GB18145 and WI10.0504 final inspection standard.

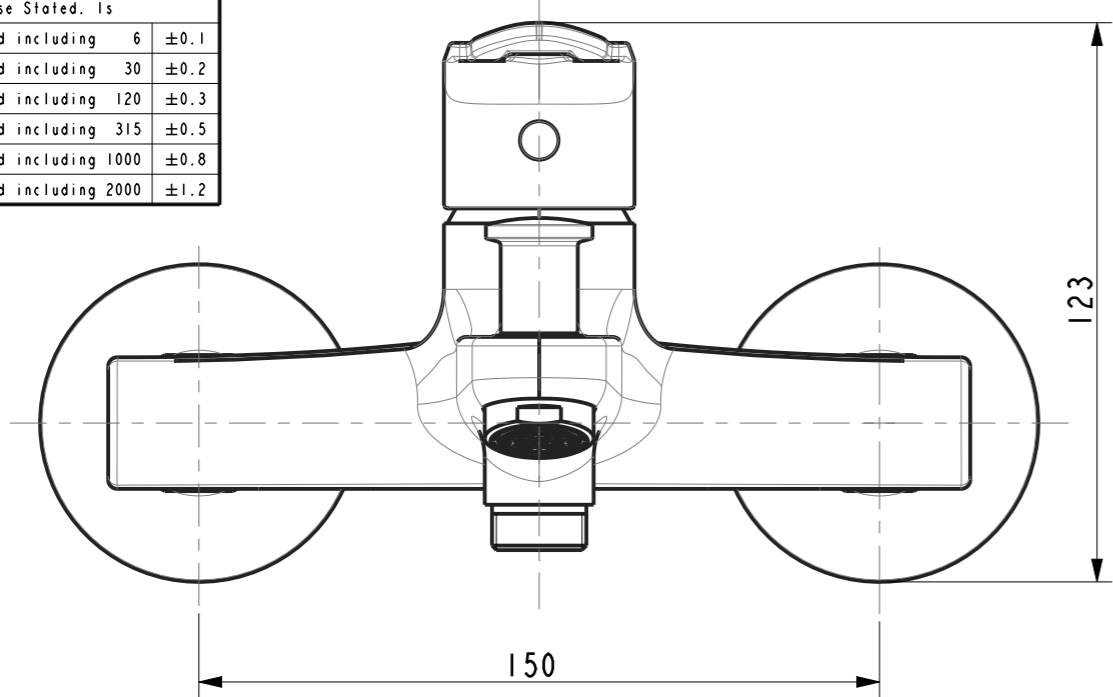
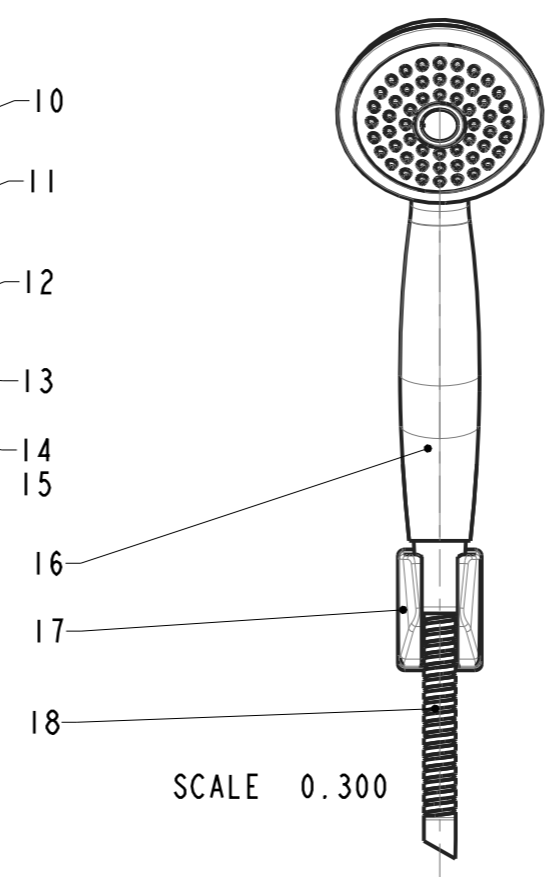
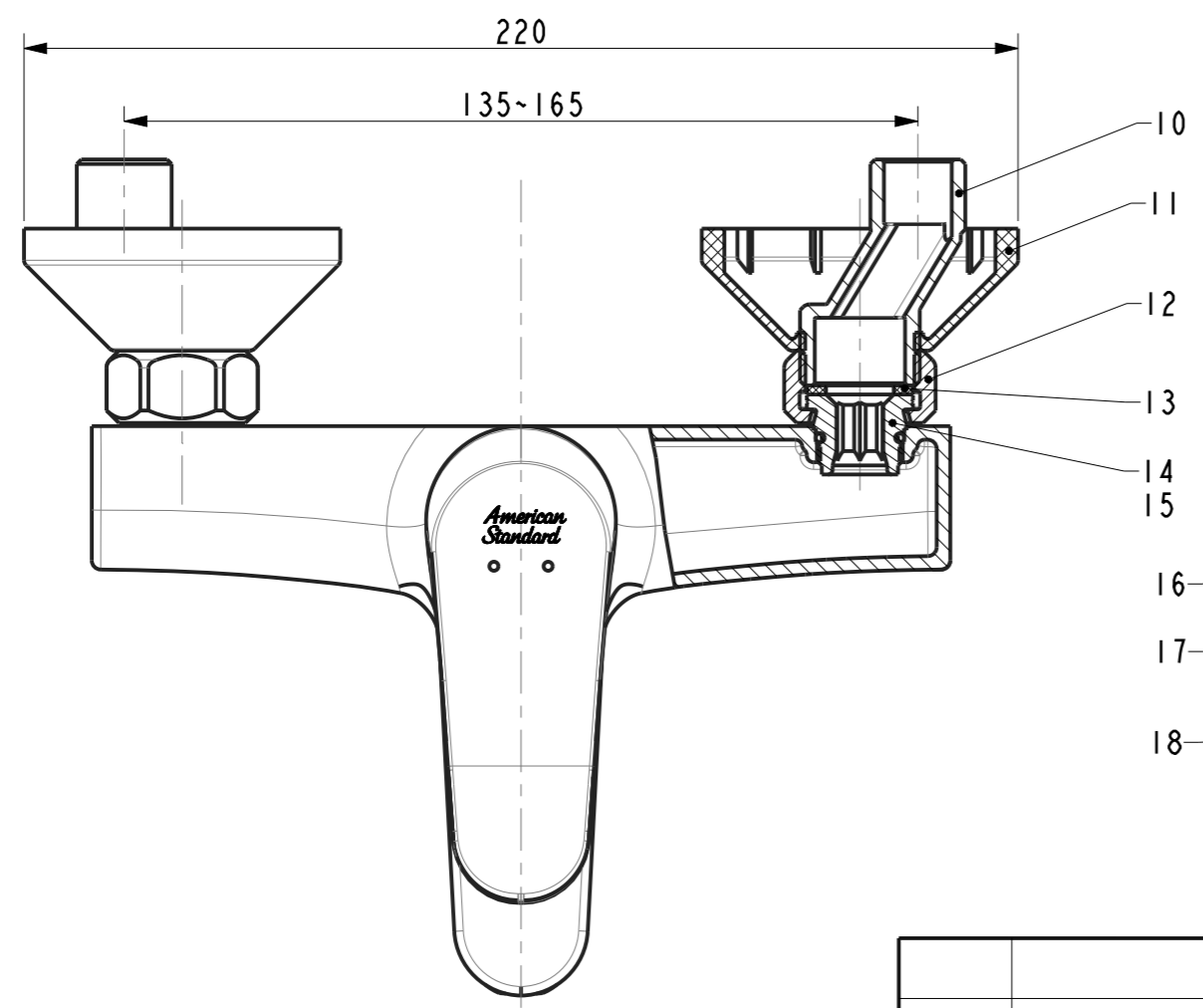

18	FF1-CN521T00000025	Shower Hose(1.5M)	1	Assembly	
17	FF1-CN521H00000055	RG Shower Hanger Sgl Hole (Cr) T2	1	ABS	Chrome
16	FF1-CN521H00001850	Hand Shower(Single Function)	1	Assembly	
15	FF1-CN521G00000112	O-Ring 15.6*1.78	2	NBR70	
14	FF1-CN521W00000048	THREADED NIPPLE,N	2	SUS304	
13	FF1-CN521G00000341	Washer	2	Fiber	
12	FF1-CN521N00000291	NUT-G3/4inch,Cr	2	Hpd59-1	
11	FF1-CN521F00000094	2000 escutcheon chrome plated	2	ABS	Chrome
10	FF1-CN521J00000242	Small S-shaped nozzles	2	SUS304	
9	FF1-CN521A00000050	Aerator for Korean Market(01.2413.0)	1	Assembly	Chrome
8	FFZ0711-60150BDPL	Body For Neo Modern Exposed B	1	GkMs60Fk	Chrome
7	FF1-CN521X00000119	Colony Diverter Cr WF-1215.6T1.50	1	Assembly	Chrome
6	FF1-CN521C00001399	C35G-1 Cartridge	1	Assembly	
5	FF1-CN521N00000091	Cartridge Nut	1	Hpd59-1	
4	FF1-CN521F00000042	Cartridge Cover	1	ABS	Chrome
3	FF1-CN521Z00000086	Index Button for TONIC Fitting line	1	ABS	
2	FF1-CN521N000000899	In-Hex Screw M5*6	1	SUS304	
1	FF1-CN521L00000091	Handle for Neo Modern Line	1	ZZnAL4-1	Chrome
NO.	PART NO.	PART NAME	QTY	MATERIAL	FINISH

DESIGNED	TITLE
CHECKED	REF
APPROVED	Neo Modern EX BS Mixer
SCALE	DWG NO.
MATERIAL	FFAS0711-60150BF0
WEIGHT	American Standard

REV	DESCRIPTION	DATE	NAME