

Tolerance, Unless Otherwise Stated, Is			
Above 0.5 to and including 6	6		±0.1
Excess 6 to and including 30	30		±0.2
Excess 30 to and including 120	120		±0.3
Excess 120 to and including 315	315		±0.5
Excess 315 to and including 1000	1000		±0.8
Excess 1000 to and including 2000	2000		±1.2

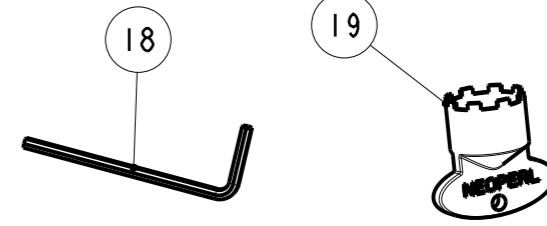
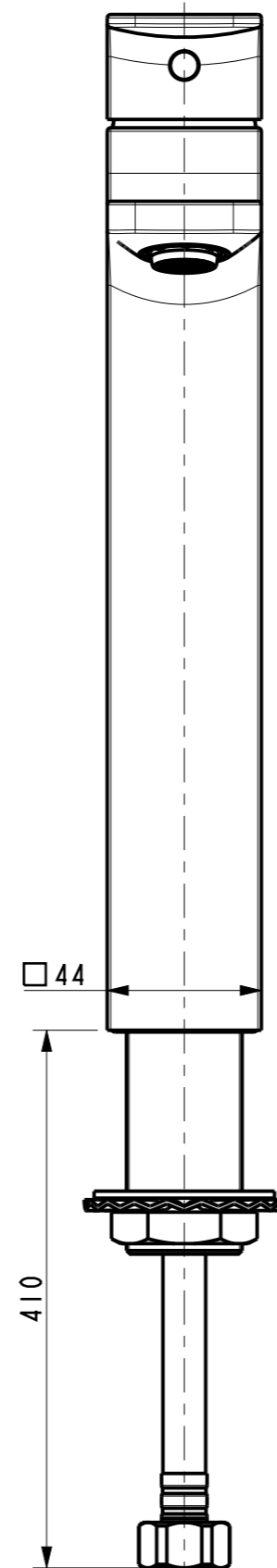
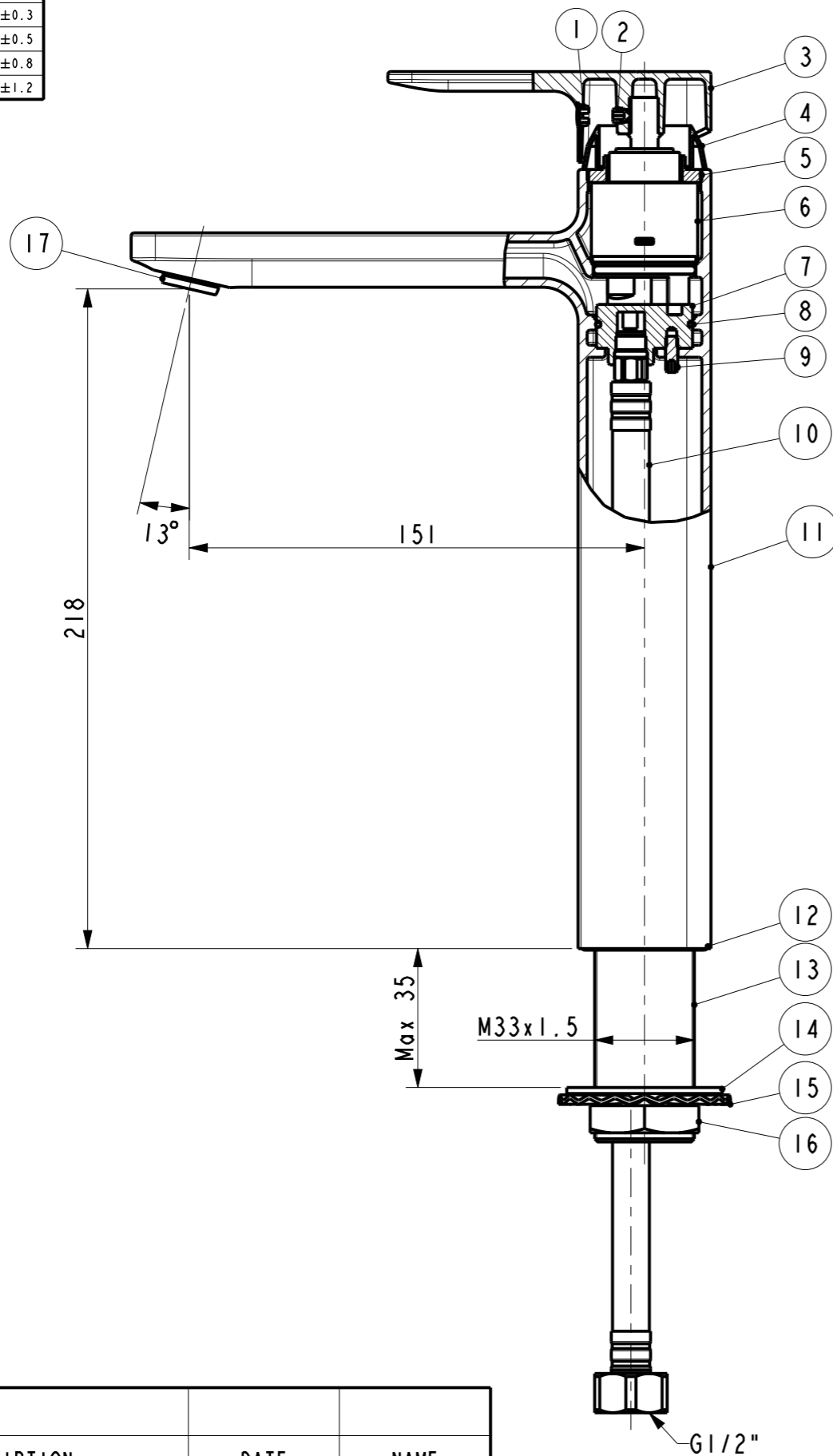

19	FF1-CN521Z00000254	In-Hex Wrench	1	Q235	
18	FF1-CN521A00000097	Aerator Key	1	PA66-GF30	
17	FF1-CN521A0001799P	M24X1 Aerator 1.5gpm	1	NBR+POM	
16	FF1-CN521N00000296	Nut M33*1.5	1	HPb59-1	
15	FF1-CN521J00000500	Washer	1	SUS304	
14	FF1-CN521G00000056	Washer 51.5*36*2	1	NBR	
13	FF1-CN521J00000271	Lock Teeth(M33*1.5)	1	HPb59-1	
12	FF1-CN521G00000159	O-Ring 37*2.5	1	NBR	
11	FFZZ1302-10150BDPL	Body	1	GkMs60Fk	CP
10	FF1-CN521T00000019	Flexible Hose	1	Assembly	
9	FF1-CN521N00000176	Bolt M4*15	1	SUS304	
8	FF1-CN521G00000247	O-ring 26.70*1.78	1	NBR	
7	FF1-CN521J00000575	Maifold	1	HPb59-1	
6	FF1-CN521C00001399	C35G-1 Cartridge	1	Assembly	
5	FF1-CN521N00000096	Lock Nut	1	HPb59-1	
4	FF1-CN521F0004050P	Cartridge Cover	1	ABS	CP
3	FF1-CN521L00000199	Handle	1	ZZnA14-1	CP
2	FF1-CN521N00000228	Screw M5*6	1	SUS304	
1	FF1-CN521Z00004950	Plug for handle	1	ABS	CP
No.	Part No.	Part Name	Qty	Material	Finish

DESIGNED			TITLE		
CHECKED			REF		
APPROVED			Acacia E Extended Basin Mono		
SCALE	MATERIAL	WEIGHT	DWG NO.		<i>American Standard</i>
1:2	Assembly		FFAS1308-101500BF0		

REV	DESCRIPTION	DATE	NAME