

Tolerance, Unless Otherwise Stated, Is			
Above	0.5 to and including	6	±0.1
Excess	6 to and including	30	±0.2
Excess	30 to and including	120	±0.3
Excess	120 to and including	315	±0.5
Excess	315 to and including	1000	±0.8
Excess	1000 to and including	2000	±1.2

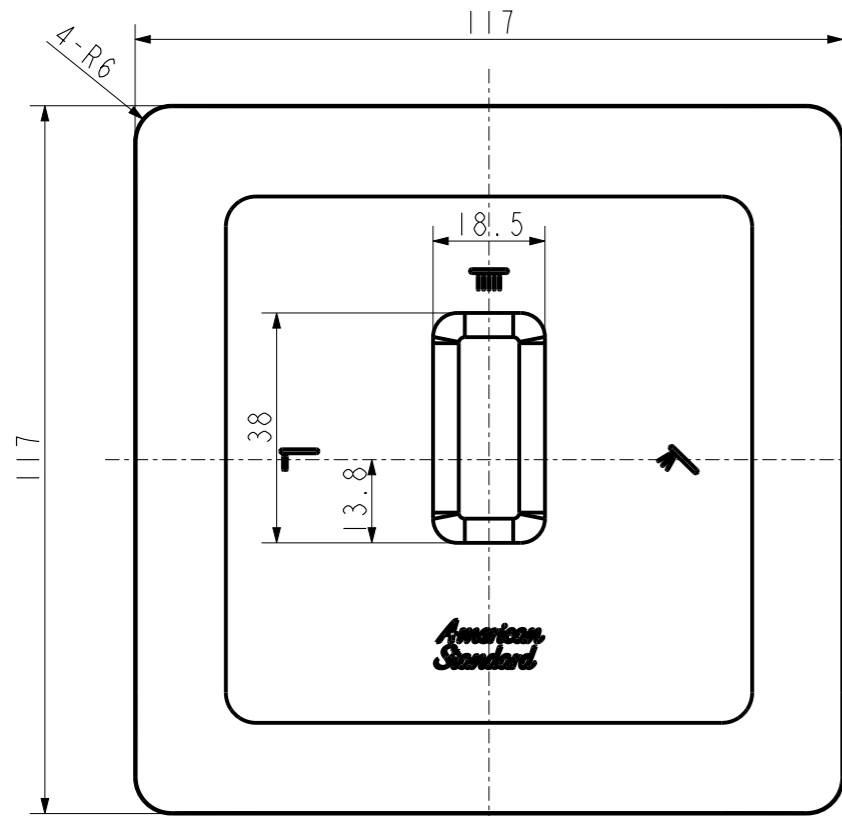

比例 0.800

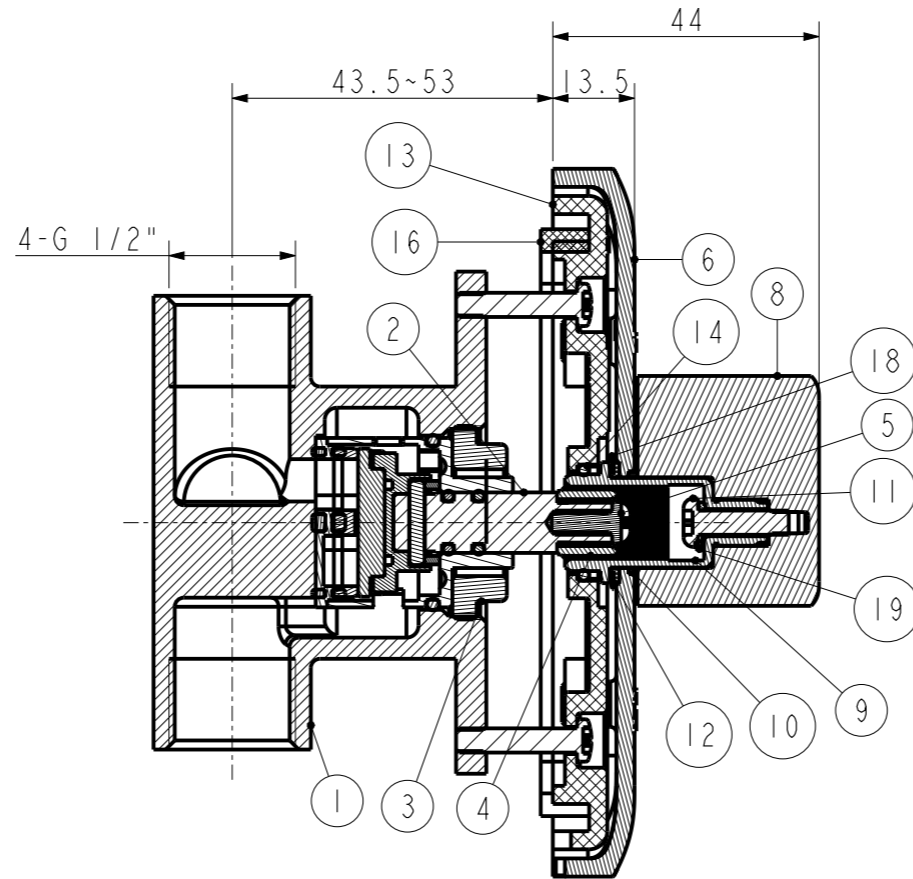

截面 A-A

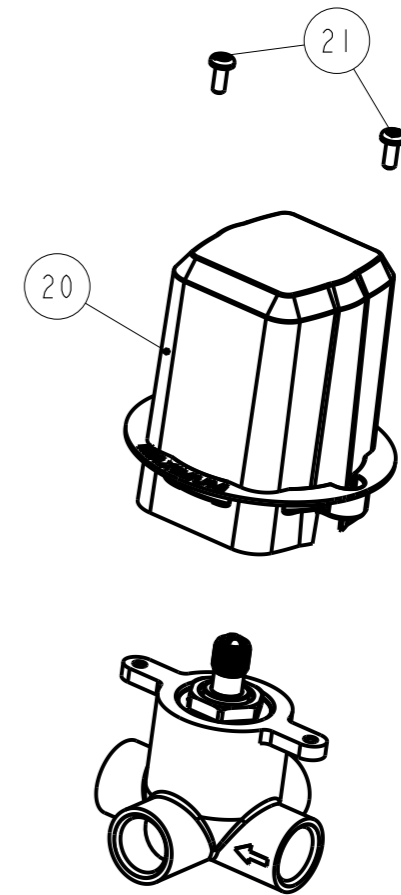

No.	Part No.	Part Name (EN)	Part Name (CN)	QTY	Material	Finished
21	FF1-CN521N00000194	2002 Screw (Zinc)	15818609F42002 保护套螺钉	2	SUS304	
20	FF1-CN521200000212	1582241099\Protect Cover for Inwall(47#)	1582240799\入墙淋浴保护套(47#)	1	PP	
19	FF1-CN521200000157	1581520399\Spring Washer 5(GB/T 93-198)	1581520399\弹簧垫圈 5(GB/T 93-1987)	1	65Mn	
18	FF1-CN521W00000011	Wahser Φ20xΦ15x1.5	1581183899\弹性垫片	1	Brass	
17	FF1-CN521N00000268	Screw (M4X20)	158K618253\螺钉(M4X20)	2	SUS304	
16	FF1-CN521K00000034	1581193599\Foam Washer for Noble In-Wal	新典入墙面板胶垫(海绵垫)4*8*570mm	1	EVA	
15	FF1-CN521G00000291	O-Ring(7X2)(Water Mark)	158A912789\O环(7X2)(Water Mark)	4	NBR	
14	FF1-CN521G00000112	O-Ring 15.6*1.78	1581212699\O型圈 15.6*1.78	1	NBR	
13	4266939990	Fixing Plate for Acacia SS Diverter 3Way	Acacia SS 入墙3路切换控制阀面板固定板	1	ABS	
12	4271589990	Wahser Φ20xΦ15x1.5	平垫片 (Φ20xΦ15x1.5)	1	Nylon	
11	FF1-CN521N00000165	Screw M4*15	1581835499\螺钉 M4*15	1	SUS304	
10	4271059990	Wahser Φ16.8xΦ15x2.5	平垫片 (Φ16.8xΦ15x2.5)	1	Nylon	
9	4266589990	Handle Adapter for for Acacia SS Concealed Diverter 3Way	Acacia SS 入墙3路切换控制阀把手连接杆	1	HPb59-1	
8	4266700000	Handle for Acacia SS Concealed Diverter 3Way	Acacia SS 入墙3路切换控制阀把手	1	ZZnAl4-1	CP
7	FF1-CN521J00000214	158180199U\Fix Pin for Universal Conceal	158180199U\入墙面板通用固定销钉	4	HPb59-1	
6	4266830000	Escutcheon for Acacia SS Diverter 3Way	Acacia SS 入墙3路切换控制阀面板	1	ZZnAl4-1	CP
5	FF1-CN521N00000161	Fairline Tap Handle Serew	1581834599\泛莱立挂把手螺钉	1	HPb59-1	
4	4266599990	Adapter for Acacia SS (20-48 Spline)	齿套 (20齿-48齿)	1	HPb59-1	
3	FF1-CN521N00000006	1580225599\Nut for Ventuno Single Hole L	1580225599\嵌紧螺母	1	HPb59-1	
2	FF1-CN521C0003199P	28mm 3-way diverter	28mm 3方向切换阀芯	1	Assembly	
1	4266279990	Body for Acacia SS Diverter 3Way	Acacia SS 入墙3路切换控制阀本体 (AA, 加工件)	1	GkMs60Fk	

Technical requirements 技术要求:

- Cartridge tightening torque is 8~10 N.m and the other torque is implemented according to the (W109.1520 assembly torque specification); 阀芯安装扭力为8~10N.m, 其它符合W109.1520要求.
- O-ring coated lubricating oil DCIII; O环需涂油DCIII.
- The product should meet GB 18145 and W110.0504 Final inspection standard-faucet; 产品需符合GB18145要求, 外观需符合W110.0504要求.

REV	DESCRIPTION	DATE	NAME

DESIGNED	CHECKED	APPROVED	SCALE	MATERIAL	WEIGHT	DWG NO.	TITLE
阮国林	阮国林	阮国林	4:5	组件/Assembly		1131320000	Acacia SS Concealed Diverter 3-way(APAC)
							REF 新阿卡西亚舒薄丽墙式三路切换阀 (APAC)
							American Standard