

# 61000NS-WT

American Standard

## Seat&Cover Installation Manual

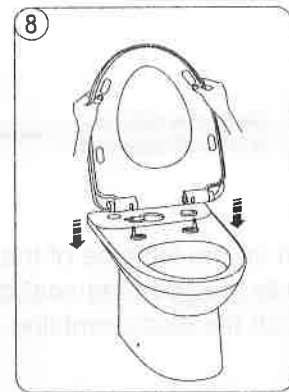
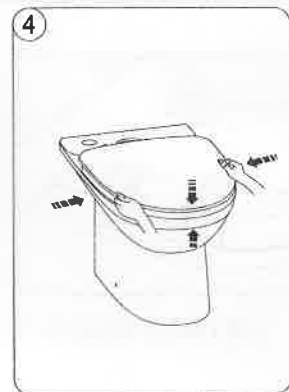
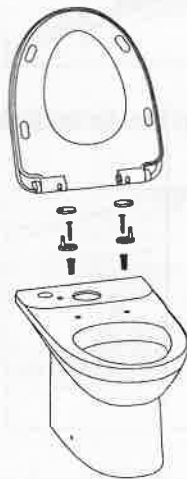

# Replace dampers for the S&C

## S&C disassembling

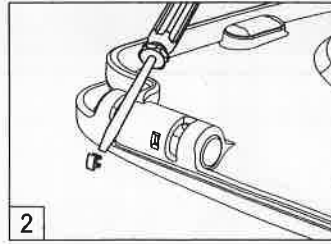
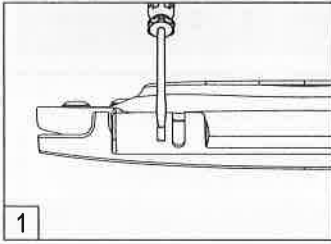

1) Use screwdriver, knife or any similar sharp tool to take out the buckle.

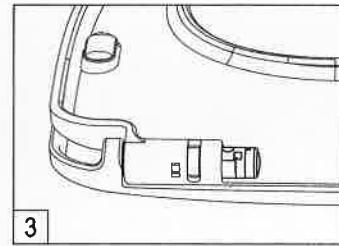
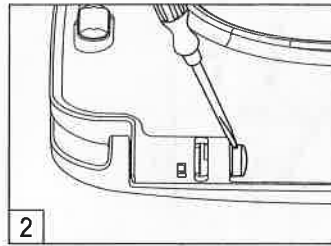
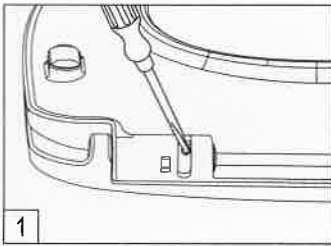

2) Use screwdriver, knife or any similar sharp tool to push soft-close set towards the right side, until expose the small hole on the press button, stick the hole and then push it towards right side until can not move further.

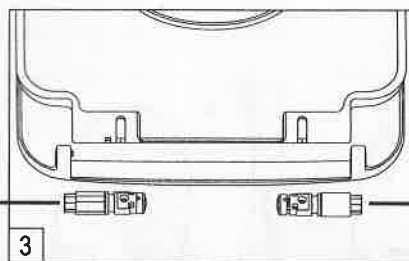
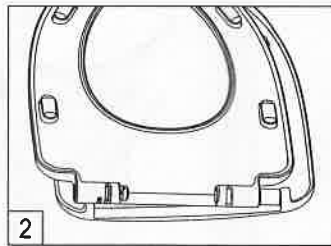
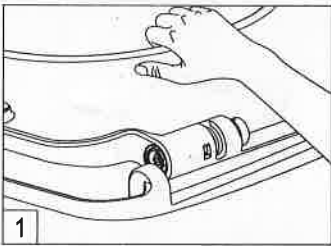

Black one with ribs  
is left soft-close set

White one without ribs  
is right soft close set

3) Lift up the left side of the seat slightly (Don't use too much power to avoid damage of S&C, lift it up to the point the seat can leave the cover. ), and then pull out the seat towards the left side to finish the disassembling.

# Replace dampers for the S&C

## S&C assembling

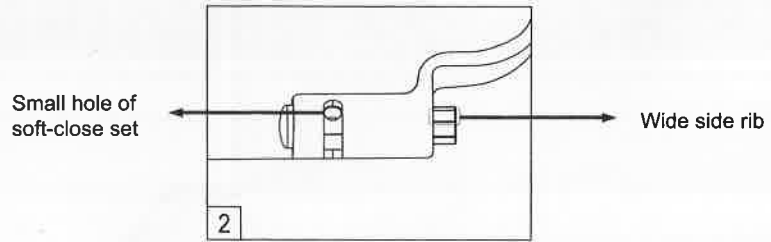
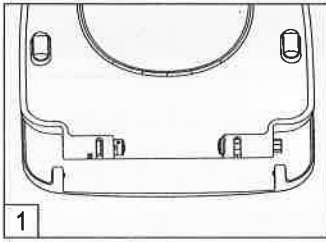

- 1) Put left and right soft-close set into the seat, make sure the small hole of the soft-close set and the wide side rib is upward.

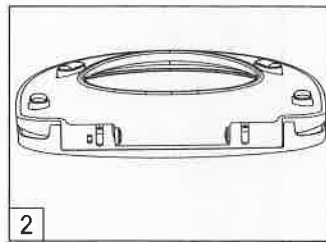
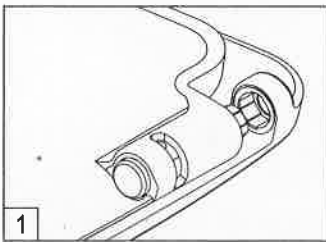

- 2) Assemble right soft-close set, set small hole and wide side rib upward and then push it into the cover.

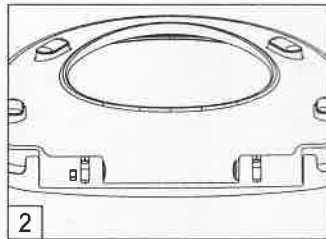
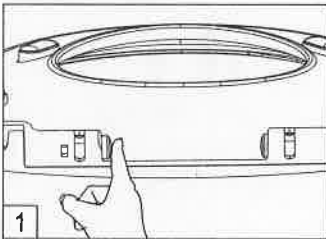

- 3) Assemble left soft-close set, set small hole and wide side rib upward and then push it into the cover.

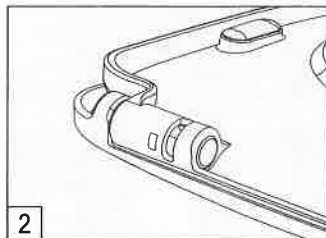
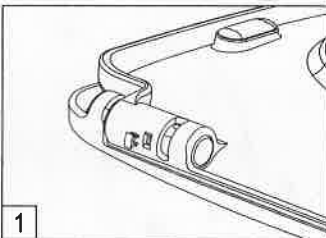

- 4) Put the buckle onto the buckle hole, use a hammer to knock it slightly until it is locked tightly, and then finish the assembling.