

Neo Modern

Extended Basin Mono
FFAS0707-101500BF0



FEATURES

- Water Saving
- EcoStart
- Durashine

SPECIFICATIONS

- 25mm Ceramic Disc Cartridge, Life Cycle: 500,000 cycle
- Zinc Die Casting Handle, Chrome Finish
- Cast Brass Body, Chrome Finish
- W/ Neoperl M24X1 Aerator, Flow Rate is less than 6L/min at 1bar
- W/ 600mm Flexible Hose
- W/o Pop-up Drain
- Surface Treatment: Ni \geq 6.0u, Cr \geq 0.2u
- Water Pressure: 0.5bar ~ 7.5bar
- Recommended Water Pressure: 1bar ~ 5bar

FINISHES AVAILABILITY

- Chrome (- CP)

SHIPPING WEIGHT

- Gross Weight: 2.184 KG

STANDARDS CRITERIA

- TIS 2067-2544

DIMENSIONAL DRAWING

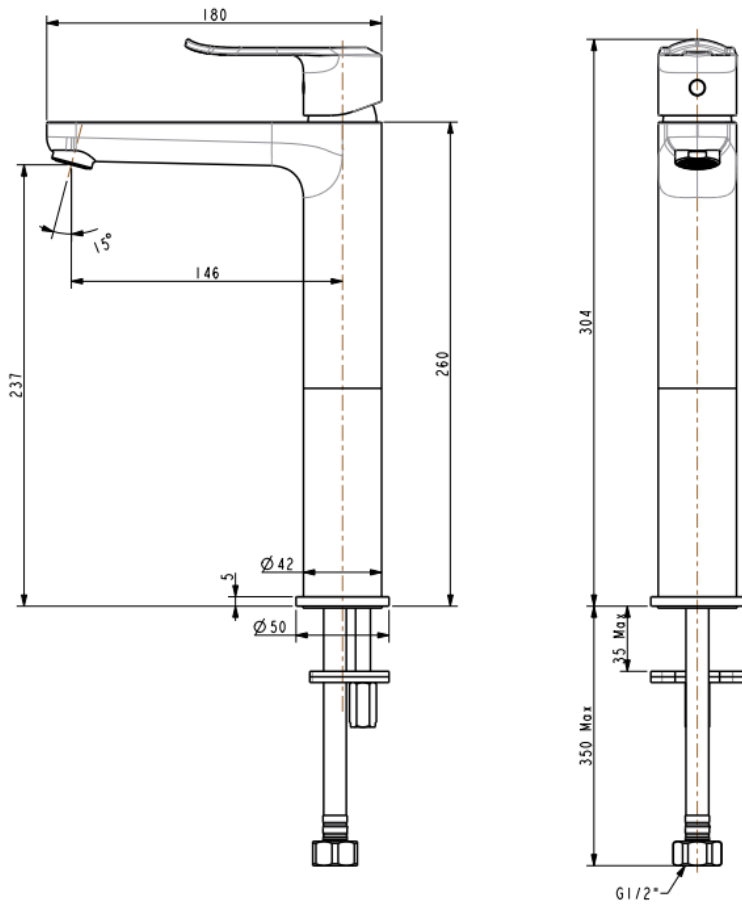

This document is the property of American Standard. It can neither be reproduced, nor communicated, without authorization.

American Standard reserves the right to change dimensions and specifications without notice; we assume no liability for the use of obsolete dimensions.